

QUICK START GUIDE

2701 - Falls Monitor with Safetime

Step 1

Insert 3 x AA Alkaline Batteries. (Do not use rechargeable batteries.)

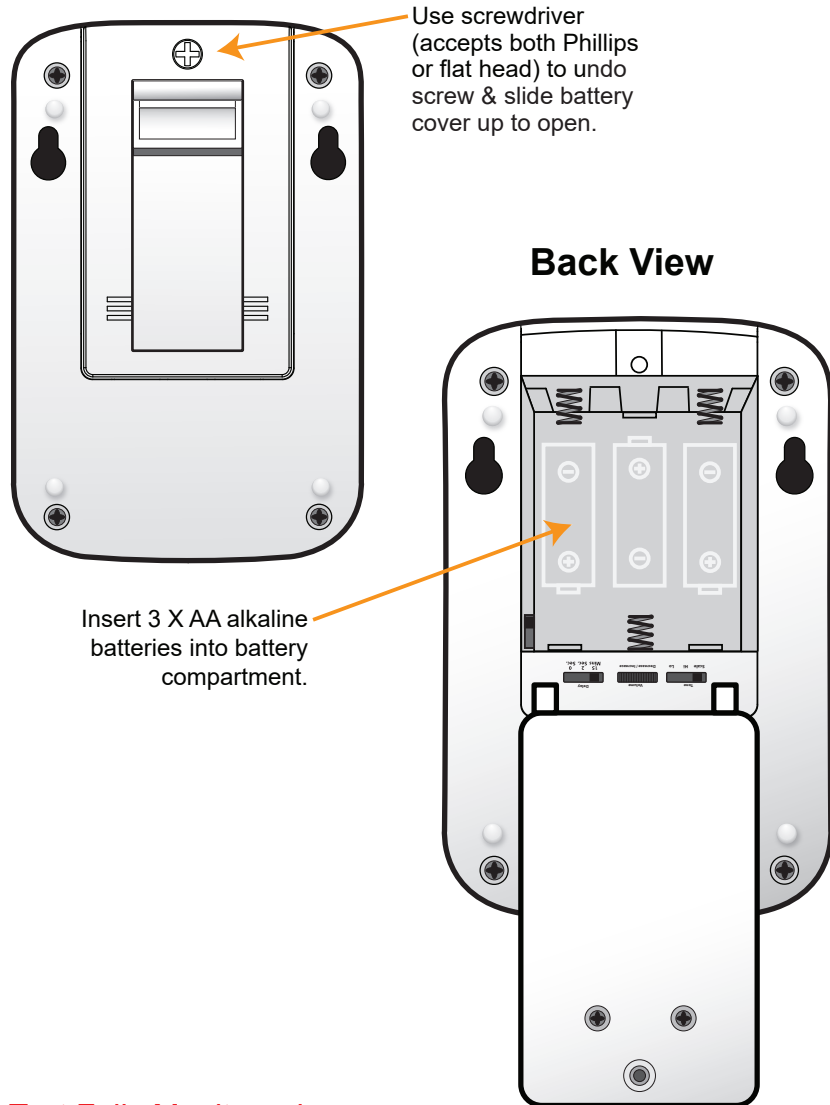

Test Falls Monitor prior to every use.

Step 2

Connect Pad or Floor Mat to Monitor & test prior to using.

Bottom View

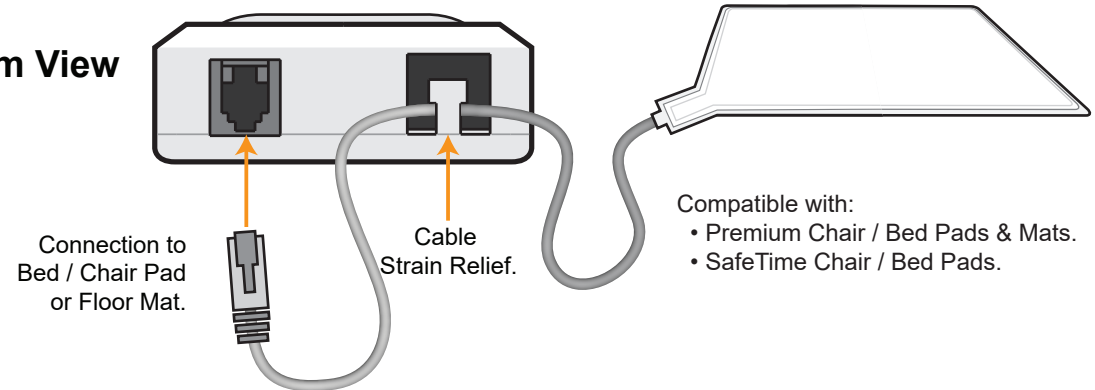

Step 3

Place Bed Pad on mattress or position Mat on floor.

